

ASI 100

## Think Quality!



Aptech Africa manufactures and installs its own solar panels under the brand Aptech Solar. These panels are designed and manufactured to meet all European standards and certifications. All panels from Aptech Solar come with a 25 year warranty.

- Durable design make them perfect for high winds and hot temperatures in East Africa
- Power output guaranteed (0-+3%)
- Monocrystalline solar cells are able to convert the highest amount of solar electricity, making it the most efficient solar technology available
- Sleek black frame and design make for aesthetic appearance
- High efficiency solar charging which works even on cloudy days
- Concrete design make them ideal for urban settings or where space is limited
- Quality design comes with 10 year product warranty and 25 year power warranty
- Manufactured according to International Quality and Environment Management System



- 10-year limited product warranty
- Limited power warranty: 12 years at 90% of the minimal rated power output, 25 years at 80% of the minimal rates power output

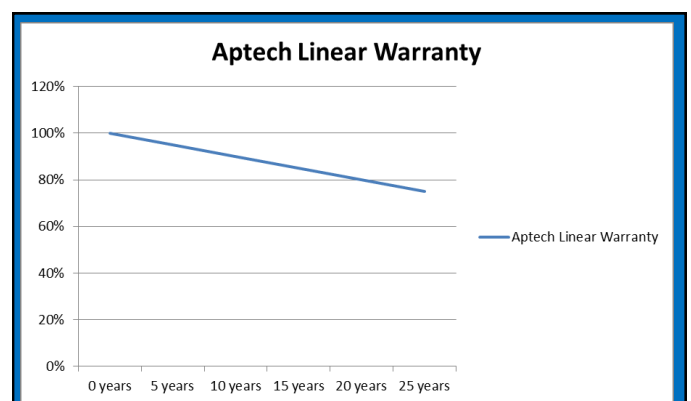

## 100W Solar PV Monocrystalline Solar Panel

### Electrical Specifications:

Model	AS 100
Rating Power at STC	100W
Rating Power Voltage (V)	18.2
Rating Power Current (A)	5.52
Open-Circuit Voltage (V)	22.7
Short-Circuit Current (A)	5.92
Cell Efficiency	16.2%
Module Efficiency	13.7%
Temperature Coefficient of Isc	0.065%/C degrees
Temperature of Coefficient of Voc	-0.330%/C degrees
Operating Temperature	-40 C– 85 C
NOCT	45+/- 2 C
Series Fuse Rating (A)	10
Application Grade	A
Fire-Resistance Grade	C
Wind-Resistance Grade	210 Km/h
Bear Hail Capability (80Km/h)	Minimum 25mm in Diameter
Resistance to Corrosion	Applicable for Islands
Power Tolerance	0-+5W
Water Proof Grade	IP65
Front Cover	Low Iron Toughened Glass
Rear Cover	TPT
Encapsulation Material	EVA
Frame Parts	Aluminum Glue
Adhesive (Frame)	Silicon Glue
Diode Number	6
Cell Connectors	CU
Junction Box	PPO

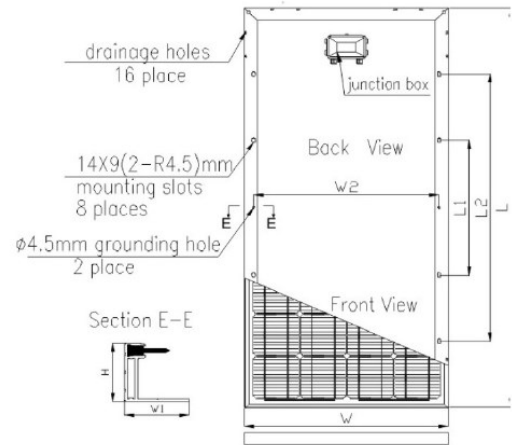

### Mechanical Specifications:

Model	AS 100
H (mm)	35
L (mm)	1336
L1 (mm)	536
L2 (mm)	935
W (mm)	550
W1 (mm)	35
W2 (mm)	500
Array (Pcs)	4 x 10
Cell Dimension (mm)	125 x 125
Weight (kgs)	7.8

### Guarantee:

- 10-year product guarantee
- 12-Year performance guarantee at 90% power output
- 25– Year performance guarantee at 80% power output